



**DEPARTMENT OF PUBLIC WORKS
CITY ENGINEERING DIVISION**

Coleman A. Young Municipal Center
2 Woodward Ave., Suite 601
Detroit, Michigan 48226

Phone 313•224•3949 TTY: 711
Fax 313•224•3471
www.detroitmi.gov

May 15, 2025

Honorable City Council:

RE: Petition No. x2025-114 – 660 Woodward Associates, LLC, request for encroachment within the southerly part of Cadillac Square, adjacent to the parcel commonly known as 660 Woodward Ave., for the installation of an on-site building-mounted advertising sign and a concrete stair and wheelchair ramp.

Petition No. x2025-114 – 660 Woodward Associates, LLC, request for encroachment within the southerly part of Cadillac Square, 200 ft. wide, adjacent to the parcel commonly known as 660 Woodward Ave., for the installation of an on-site building-mounted advertising sign and a concrete stair and wheelchair ramp.

The petition was referred to the City Engineering Division – DPW for investigation and report. This is our report.

The request was approved by the Solid Waste Division – DPW, and City Engineering Division – DPW. Traffic Engineering Division

Detroit Water and Sewerage Department (DWSD) reports being involved, but they have no objection provided the DWSD encroachment provisions are followed. The DWSD provisions have been made a part of the resolution.

All other involved City Departments, including the Public Lighting Authority and Public Lighting Department; also privately owned utility companies have reported no objections to the encroachment. Provisions protecting all utility installations are part of the attached resolution.

I am recommending adoption of the attached resolution.

Respectfully submitted,

Richard Doherty, P.E., City Engineer
City Engineering Division – DPW

Cc: Ron Brundidge, Director, DPW
Mayor's Office – City Council Liaison

COUNCIL MEMBER _____

RESOLVED, that the Department of Public Works, City Engineering Division is hereby authorized and directed to issue permits to 660 Woodward Associates, LLC or their assigns to install and maintain various encroachments within Cadillac Square, further described as: Land in the City of Detroit, Wayne County, Michigan;

1. On-site building-mounted advertising sign, within Cadillac Square, 200 ft. wide, lying northerly of and adjacent to lot 50 of "The Governor and Judges Plat of Section 1" as recorded in Liber 9, Page 424-5 of Plats, Wayne County Records. Said on-site advertising sign shall be installed ranging from 12.3' to 15.3' above grade and extend 3.0' into the southerly part of Cadillac Square.
2. Concrete stair and wheelchair ramp, measuring 10.0' x 24.0' x .08', lying northerly of and adjacent to lot 51 of "The Governor and Judges Plat of Section 1" as recorded in Liber 9, Page 424-5 of Plats, Wayne County Records. Said concrete stair and wheelchair ramp shall be installed ranging from 0.0' to 0.8' above grade and extend 10.0' into the southerly part of Cadillac Square.

RESOLVED, that the Director of the Department of Public Works, or his or her designee, is authorized to execute any document or documents necessary or convenient to make and incorporate technical amendments, corrections, or other minor changes to any document or documents necessary or convenient in furtherance of or to effectuate the action or transaction hereby approved, including the legal description of any property described herein, in the event there are any scrivener's errors, mistakes of fact, or changes in circumstances, or as may be required to correct minor inaccuracies, or are necessitated by unforeseen circumstances or technical matters, provided that the changes do not materially alter the substance or terms of the action or transaction hereby approved;"

PROVIDED, that if there is any cost for the removing and/or rerouting of any utility facilities, it shall be done at the expense of the petitioner and/or property owner; and be it further

PROVIDED, that access is maintained to all fire department connections, and be it further

PROVIDED, that by approval of this petition the Detroit Water and Sewerage Department (DWSD) does not waive any of its rights to its facilities located in the right-of-way, and at all times, DWSD, its agents or employees, shall have the right to enter upon the right-of-way to maintain, repair, alter, service, inspect, or install its facilities. All costs incident to the damaging, dismantling, demolishing, removal and replacement of structures or other improvements herein permitted and incurred in gaining access to DWSD's facilities for maintenance, repairing, alteration, servicing or inspection caused by the encroachment shall be borne by the petitioner. All costs associated with gaining access to DWSD's facilities, which could normally be expected had the petitioner not encroached into the right-of-way, shall be borne by DWSD; and be it further

PROVIDED, that all construction performed under this petition shall not be commenced until after (5) days written notice to DWSD. Seventy-two (72) hours' notice shall also be provided in

accordance with P.A. 53 1974, as amended, utilizing the MISS DIG one call system; and be it further

PROVIDED, that construction under this petition is subject to inspection and approval by DWSD forces. The cost of such inspection shall, at the discretion of DWSD, be borne by the petitioner; and be it further

PROVIDED, that if DWSD facilities located within the right-of-way shall break or be damaged as the result of any action on the part of the petitioner, then in such event the petitioner agrees to be liable for all costs incident to the repair, replacement or relocation of such broken or damaged DWSD facilities; and be it further

PROVIDED, that the petitioner shall hold DWSD harmless for any damages to the encroaching device constructed or installed under this petition which may be caused by the failure of DWSD's facilities; and be it further

PROVIDED, 660 Woodward Associates, LLC or their assigns shall apply to the Buildings and Safety Engineering Department for a building permit prior to any construction. Also, if it becomes necessary to open cut public streets, bore, jack, occupy or barricade city rights-of-way for maintenance of encroachments such work shall be according to detail permit application drawings submitted to the City Engineering Division – DPW prior to any public right-of-way construction; and further

PROVIDED, that the necessary permits shall be obtained from the City Engineering Division – DPW and the Buildings and Safety Engineering Department. The encroachments shall be constructed and maintained under their rules and regulations; and further

PROVIDED, that all cost for the construction, maintenance, permits and use of the encroachments shall be borne by 660 Woodward Associates, LLC or their assigns, and further

PROVIDED, that all costs incurred by privately owned utility companies and/or city departments to alter, adjust, and/or relocate their existing utility facilities located in close proximity to the encroachments shall be borne by 660 Woodward Associates, LLC or their assigns. Should damages to utilities occur 660 Woodward Associates, LLC or their assigns shall be liable for all incidental repair costs and waives all claims for damages to the encroaching installations; and further

PROVIDED, that no other rights in the public streets, alleys or other public place shall be considered waived by this permission which is granted expressly on the condition that said encroachments shall be removed at any time when so directed by the City Council, and the public property affected shall be restored to a condition satisfactory to the City Engineering Division – DPW; and further

PROVIDED, that 660 Woodward Associates, LLC or their assigns shall file with the Department of Public Works – City Engineering Division an indemnity agreement in form approved by the Law Department. The agreement shall save and protect the City of Detroit from any and all claims,

damages or expenses that may arise by reason of the issuance of the permits and the faithful or unfaithful performance of 660 Woodward Associates, LLC or their assigns of the terms thereof. Further, 660 Woodward Associates, LLC or their assigns shall agree to pay all claims, damages or expenses that may arise out of the use, repair and maintenance of the proposed encroachments; and further

PROVIDED, that construction of the encroachments shall constitute acceptance of the terms and conditions as set forth in this resolution; and be it further

PROVIDED, this resolution is revocable at the will, whim or caprice of the City Council, and 660 Woodward Associates, LLC acquires no implied or other privileges hereunder not expressly stated herein; and further

PROVIDED, that the encroachment permits shall not be assigned or transferred without the written approval of the City Council; and be it further

PROVIDED, that the City Clerk shall within 30 days record a certified copy of this resolution with the Wayne County Register of Deeds.

MAP-25-38

CADILLAC SQUARE 200 FT. WD.

WOODWARD AVE. 190 FT. WD.

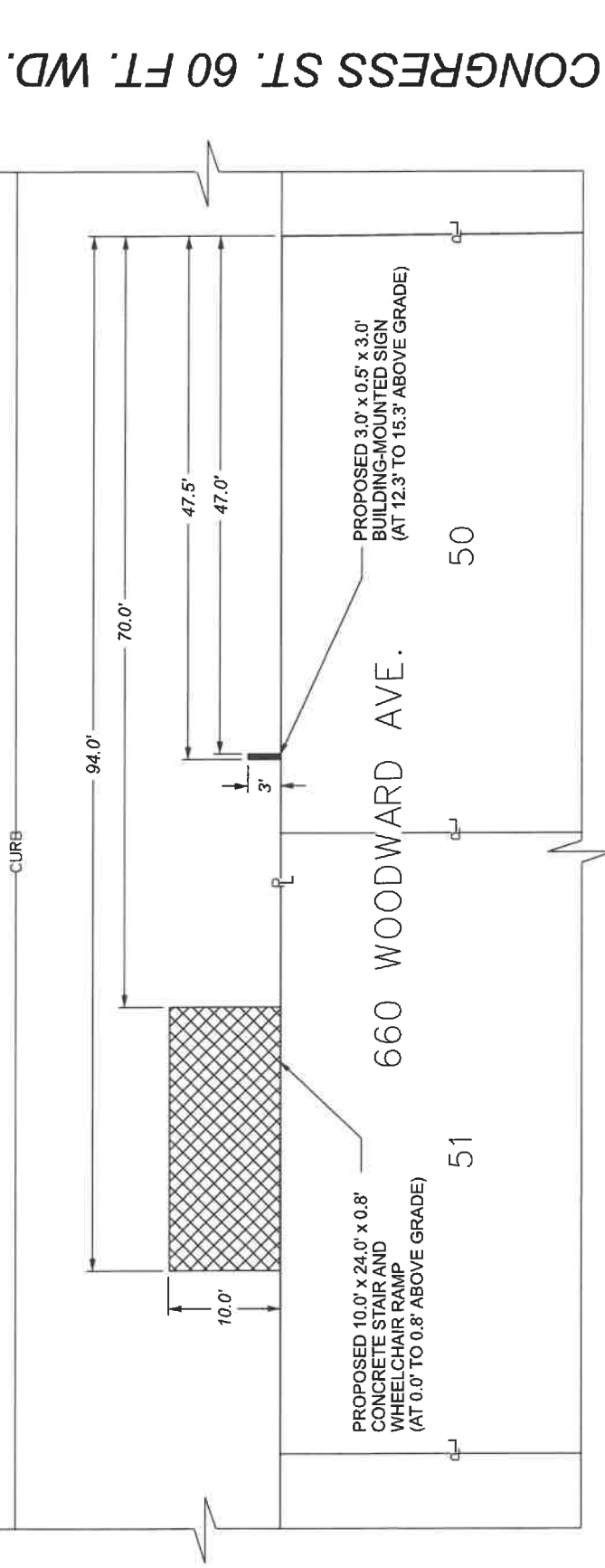

CONGRESS ST. 60 FT. WD.

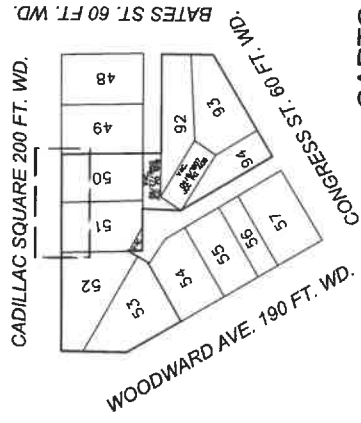

- REQUEST ENCROACHMENT (FOR BUILDING-MOUNTED SIGN)
- REQUEST ENCROACHMENT (FOR CONCRETE STAIR AND WHEELCHAIR RAMP)

(FOR OFFICE USE ONLY)

CARTO 28 F

B									
A									
DESCRIPTION		DRWN	CHKD	APPD	DATE				
DRAWN BY		TS		AP/LC					
DATE		04-22-2025		APPROVED		GE			

REQUEST ENCROACHMENTS INTO
CADILLAC SQUARE
AT 660 WOODWARD AVE.

CITY OF DETROIT
CITY ENGINEERING DIVISION
SURVEY BUREAU
JOB NO. 25-38
DRWG. NO.



PROPOSED PROJECT

The First National Building is a 26-story office building with ground floor commercial uses located at the southeast corner of Woodward Avenue and Cadillac Square. A Chick-Fil-A restaurant is proposed in one of the vacant spaces adjacent to Cadillac Square, directly east of Central Kitchen + Bar. The restaurant would be walk-in only and not include drive-up or drive-through service. The proposed exterior changes include:

- Demolition of a window and installation of a door
- Installation of steps, a ramp, and handrails
- Installation of two signs – a wall sign above the door and a projecting sign

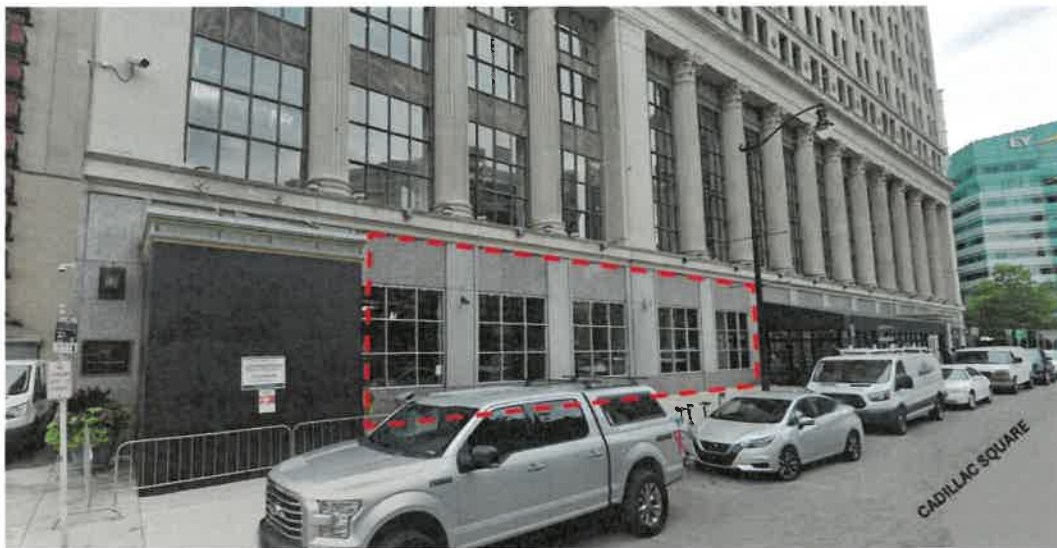

Existing condition of area proposed for alterations



Rendering of proposed alterations