



**DEPARTMENT OF PUBLIC  
WORKS**

Coleman A. Young Municipal Center  
2 Woodward, Suite 601  
Detroit, Michigan 48226

Phone 313•224•3949 TTY: 711  
Fax 313•224•3471  
www.detroitmi.gov

October 17, 2024

Honorable City Council:

**RE: Petition No. x2024-341 – Left Field 2020 LDHA LLC, request for encroachment within the easterly part of Cochrane Ave, between Fisher Freeway and Michigan Ave., for the purposes of access stairs and a concrete pad.**

Petition No. x2024-341 – Left Field 2020 LDHA, LLC request for encroachment within the easterly part of Cochrane Ave., 65 ft. wide, bounded by Fisher Freeway (various widths), Michigan Ave., 120 ft. wide, Trumbull Ave., 100 Ft. wide, for the purpose of access stairs and a concrete pad on a newly constructed property.

The petition was referred to the City Engineering Division – DPW for investigation and report. This is our report.

The request was approved by the Solid Waste Division – DPW, and City Engineering Division – DPW. Traffic Engineering Division

Detroit Water and Sewerage Department (DWSD) reports being involved, but they have no objection provided the DWSD encroachment provisions are followed. The DWSD provisions have been made a part of the resolution.

All other involved City Departments, including the Public Lighting Authority and Public Lighting Department; also privately owned utility companies have reported no objections to the encroachment. Provisions protecting all utility installations are part of the attached resolution.

I am recommending adoption of the attached resolution.

Respectfully submitted,

Richard Doherty, P.E., City Engineer  
City Engineering Division – DPW

Cc: Ron Brundidge, Director, DPW  
Mayor's Office – City Council Liaison

COUNCIL MEMBER \_\_\_\_\_

**RESOLVED**, that the Department of Public Works, City Engineering Division is hereby authorized and directed to issue permits to Left Field 2020 LDHA LLC or their assigns to install and maintain various encroachments within Cochrane Ave., 65 ft. wide, further described as: Land in the City of Detroit, Wayne County, Michigan;

Encroachment into Cochrane Ave., 65 ft. wide, five stairways and one concrete pad; the concrete pad shall be 6' wide and extend 6.6' into the easterly part of Cochrane Ave., the five sets of stairways shall measure 8.5' by 6.6' by 1.5' and extend 6.6' into the easterly part of Cochrane Ave. Said concrete pad and five stairways lying easterly of and adjacent to lots 116 through 109, including a 50' wide portion of formerly vacated on 6/8/2021 Cherry St. (JCC PG 1256), of "Plat of Julianna T. Abbott's Subdivision of Out Lot 89 and that part of the Woodbridge Grove, between Cherry and Pine Streets, Woodbridge Farm": as recorded in Liber 5, Page 36 of Plats, Wayne County Records.

**RESOLVED**, that the Director of the Department of Public Works, or his or her designee, is authorized to execute any document or documents necessary or convenient to make and incorporate technical amendments, corrections, or other minor changes to any document or documents necessary or convenient in furtherance of or to effectuate the action or transaction hereby approved, including the legal description of any property described herein, in the event there are any scrivener's errors, mistakes of fact, or changes in circumstances, or as may be required to correct minor inaccuracies, or are necessitated by unforeseen circumstances or technical matters, provided that the changes do not materially alter the substance or terms of the action or transaction hereby approved;"

PROVIDED, that if there is any cost for the removing and/or rerouting of any utility facilities, it shall be done at the expense of the petitioner and/or property owner; and be it further

PROVIDED, that access is maintained to all fire department connections, and be it further

PROVIDED, that by approval of this petition the Detroit Water and Sewerage Department (DWSD) does not waive any of its rights to its facilities located in the right-of-way, and at all times, DWSD, its agents or employees, shall have the right to enter upon the right-of-way to maintain, repair, alter, service, inspect, or install its facilities. All costs incident to the damaging, dismantling, demolishing, removal and replacement of structures or other improvements herein permitted and incurred in gaining access to DWSD's facilities for maintenance, repairing, alteration, servicing or inspection caused by the encroachment shall be borne by the petitioner. All costs associated with gaining access to DWSD's facilities, which could normally be expected had the petitioner not encroached into the right-of-way, shall be borne by DWSD; and be it further

PROVIDED, that all construction performed under this petition shall not be commenced until after (5) days written notice to DWSD. Seventy-two (72) hours' notice shall also be provided in accordance with P.A. 53 1974, as amended, utilizing the MISS DIG one call system; and be it further

PROVIDED, that construction under this petition is subject to inspection and approval by DWSD forces. The cost of such inspection shall, at the discretion of DWSD, be borne by the petitioner; and be it further

PROVIDED, that if DWSD facilities located within the right-of-way shall break or be damaged as the result of any action on the part of the petitioner, then in such event the petitioner agrees to be liable for all costs incident to the repair, replacement or relocation of such broken or damaged DWSD facilities; and be it further

PROVIDED, that the petitioner shall hold DWSD harmless for any damages to the encroaching device constructed or installed under this petition which may be caused by the failure of DWSD's facilities; and be it further

PROVIDED, Left Field 2020 LDHA, LLC or their assigns shall apply to the Buildings and Safety Engineering Department for a building permit prior to any construction. Also, if it becomes necessary to open cut public streets, bore, jack, occupy or barricade city rights-of-way for maintenance of encroachments such work shall be according to detail permit application drawings submitted to the City Engineering Division – DPW prior to any public right-of-way construction; and further

PROVIDED, that the necessary permits shall be obtained from the City Engineering Division – DPW and the Buildings and Safety Engineering Department. The encroachments shall be constructed and maintained under their rules and regulations; and further

PROVIDED, that all cost for the construction, maintenance, permits and use of the encroachments shall be borne by Left Field 2020 LDHA, LLC or their assigns, and further

PROVIDED, that all costs incurred by privately owned utility companies and/or city departments to alter, adjust, and/or relocate their existing utility facilities located in close proximity to the encroachments shall be borne by Left Field 2020 LDHA, LLC or their assigns. Should damages to utilities occur Left Field 2020 LDHA, LLC or their assigns shall be liable for all incidental repair costs and waives all claims for damages to the encroaching installations; and further

PROVIDED, that no other rights in the public streets, alleys or other public place shall be considered waived by this permission which is granted expressly on the condition that said encroachments shall be removed at any time when so directed by the City Council, and the public property affected shall be restored to a condition satisfactory to the City Engineering Division – DPW; and further

PROVIDED, that Left Field 2020 LDHA, LLC or their assigns shall file with the Department of Public Works – City Engineering Division an indemnity agreement in form approved by the Law Department. The agreement shall save and protect the City of Detroit from any and all claims, damages or expenses that may arise by reason of the issuance of the permits and the faithful or unfaithful performance of Left Field 2020 LDHA, LLC or their assigns of the terms thereof. Further, Left Field 2020 LDHA, LLC or their assigns shall agree to pay all claims, damages or

expenses that may arise out of the use, repair and maintenance of the proposed encroachments; and further

PROVIDED, that construction of the encroachments shall constitute acceptance of the terms and conditions as set forth in this resolution; and be it further

PROVIDED, this resolution is revocable at the will, whim or caprice of the City Council, and Left Field 2020 LDHA, LLC acquires no implied or other privileges hereunder not expressly stated herein; and further

PROVIDED, that the encroachment permits shall not be assigned or transferred without the written approval of the City Council; and be it further

PROVIDED, that the City Clerk shall within 30 days record a certified copy of this resolution with the Wayne County Register of Deeds.

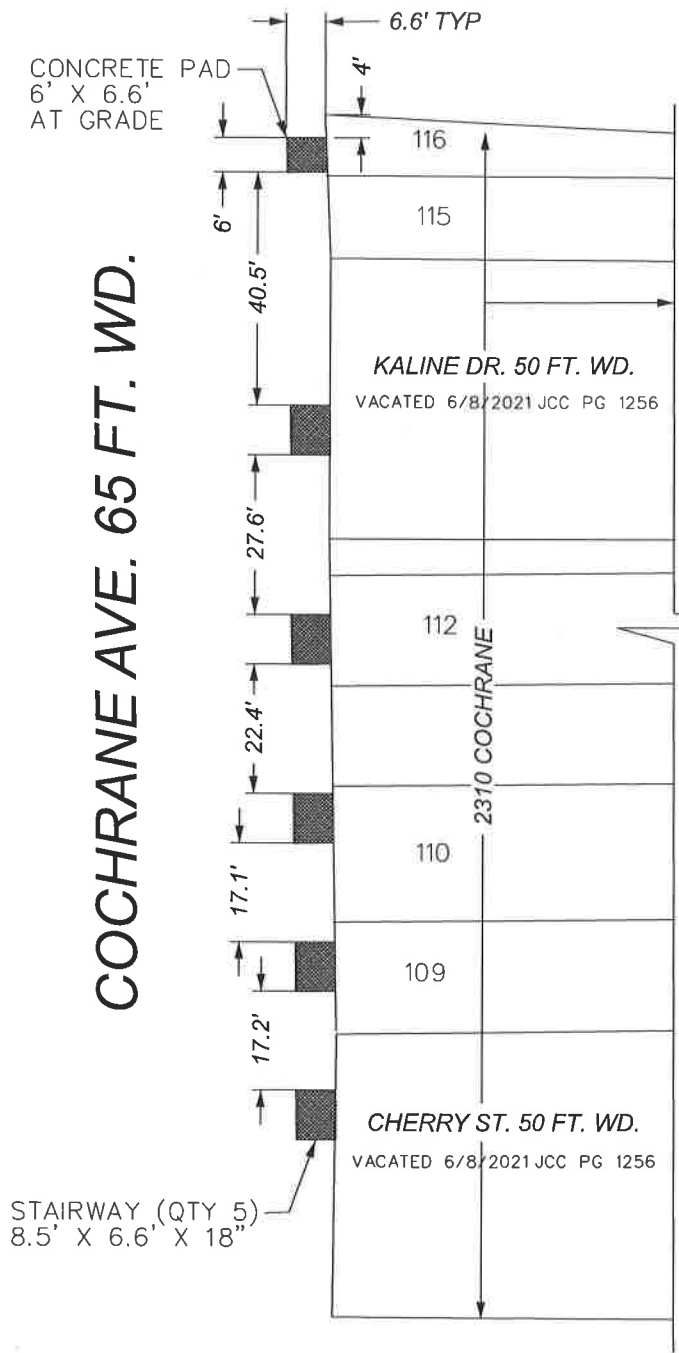

CONCRETE PAD  
6' X 6.6'  
AT GRADE

COCHRANE AVE. 65 FT. WD.

TRUMBULL AVE. 100 FT. WD.

STAIRWAY (QTY 5)  
8.5' X 6.6' X 18'

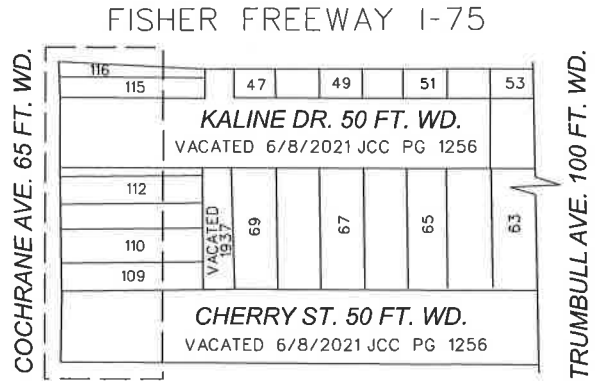

- REQUEST ENCROACHMENT  
(FOR FIVE STAIRWAYS AND ONE CONCRETE PAD)

(FOR OFFICE USE ONLY)

CARTO 29 D

B					
A					
DESCRIPTION	DRWN	CHKD	APPD	DATE	
REVISIONS					
DRAWN BY	LC	CHECKED	AP		
DATE	09-16-2024	APPROVED	RW		

REQUEST ENCROACHMENT ONTO  
COCHRANE AVE.  
AT 2310 COCHRANE AVE.  
BETWEEN CHERRY ST. AND I-75 SERVICE DR.

CITY OF DETROIT CITY ENGINEERING DIVISION SURVEY BUREAU	
JOB NO.	24-141
DRWG. NO.	